

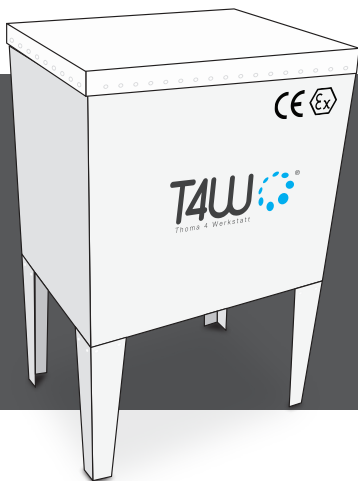

OPERATION MANUAL



INSTRUCTION FOR SPRAY
GUN WASHER

Table of Contents

1. Specification	4
2. Safety Instructions	4
3. Assembly	7
4. Air supply	7
5. Operation instructions	8
6. Cleaning	9
7. Solvent change & maintenance	9
8. Maintenance	10
EC Declaration	11



Please read the following instructions carefully.

1. Specification

The Gun Washer is suitable for the busy medium sized body shop. The tank is robustly manufactured and delivers sufficient solvent to clean two guns and pots in each washing cycle. The air supply is automatically cut off when the lid is opened. If it does not stop, you can just turn off the valve at the air inlet

Amount of Guns Washer	Max pressure (bar)	Operating pressure (bar)	Air consumption (l/min)	Noise under operation dB(A)	Width x Depth x Height (mm)	Weight (kg)
1	6,2	2,8-4,2	150	<75	420*540*1000	30
2	6,2	2,8-4,2	150	<75	470*650*1000	41,5

2. Safety Instructions



WARNING! *Note the safe operation requirements, warnings and cautions. Use this product correctly and with care for the purpose of which it is intended. Failure to do so may cause damage, and/or personal injury and will invalidate the warranty. Please keep instructions safe for future use.*

- **WARNING!** Ensure Health & Safety, local authority and general workshop practice regulations are adhered to when using equipment
- **WARNING!** Installation site must be equipped with suitable fire extinguishers (water must not be used) and escape routes.
- **WARNING!** Disconnect the air supply from the tank before changing accessories, servicing or performing any maintenance.
- Maintain the tank in good condition (use an authorized service agent).
- Replace or repair damaged parts using genuine parts only. Non-authorized parts may

be dangerous and will invalidate the warranty.

- Locate the tank in an adequate working area. Ensure the tank stands on a firm level surface. Keep area clean and tidy and free from unrelated materials. Ensure the area is well ventilated and has adequate lighting.
- **WARNING!** Ensure correct air pressure is maintained and not exceed. Recommended pressure is 2.8~4.2kg/cm².
- Keep air hose away from heat, oil and sharp edges. Check air hose for wear before each use, and ensure that all connections are secure.
- **WARNING!** This tank is recommended for use only with solvents.
- **WARNING!** We suggest the user can use xylene based or organic or water based solvents, but user has to see MSDS first and ask the agent for safety reason, and cannot disobey the local laws.
- Keep the tank clean. Clean the suction filter inside tank regularly for best performance.
- **WARNING!** Never smoke and keep sources of ignition, such as heaters, lamps, etc. away from the unit, together with flammable or combustible materials, as there is an explosion risk.
- **WARNING!** Wear approved safety eye protection, respirator and gloves. If solvent gets on skin or in eyes wash thoroughly with clean water and take any other action as required by the solvent instructions.
- Remove ill fitting clothing, ties, watches, rings and other loose jewelry, contain long hair, and wear appropriate protective clothing.
- Maintain correct balance and footing. Ensure the floor is not slippery and wear non-slip shoes.
- Keep non-essential persons away from the working area.
- In case of fire in the tank, do not attempt to move the unit when it is running.
- DO NOT use the tank with the lid open and DO NOT use it for spray gun testing.
- DO NOT use the tank for any purpose other than for which it is designed.
- DO NOT operate the tank if any parts are missing or damaged as this may cause failure and/or possible personal injury.
- DO NOT over-fill the tank (less than 19 liters).
- DO NOT direct air from the air hose at yourself or others.
- DO NOT operate the tank when you are tired or under the influence of alcohol, drugs or intoxicating medication.
- When cleaning is completed, ensure all controls are in the off position and that the air supply is turned off.
- **WARNING!** It is operator's responsibility to ensure that there is no uncontrolled discharge of any fluids used with this unit and that appropriate arrangements have been made for correct-disposal of waste in accordance with government/local

authority regulations.

- **WARNING!** The operator should be a trained and qualified technician.
- **WARNING!** DO NOT run the machine without screen platform inside the tank. It may cause the solvent spilling when opening the lid.
- DO NOT open the lid when just finished the clean. Turn the machine off by the ball valve, and wait about 30 seconds, let the solvent droplet condense to avoid inhalation of solvent vapor.
- **WARNING!** Breath a large amount of solvent may cause physical damage, and it may also do harm to pregnancy women.
- You can visit this website to see more information about MSDS
- **WARNING!** Disregarding of earth may cause fire.
- **WARNING!** Before opening the lid of tank to insert the spray gun, earth the metal body of the spray gun to bear metal contact on the cleaning machine to discharge any static electricity.

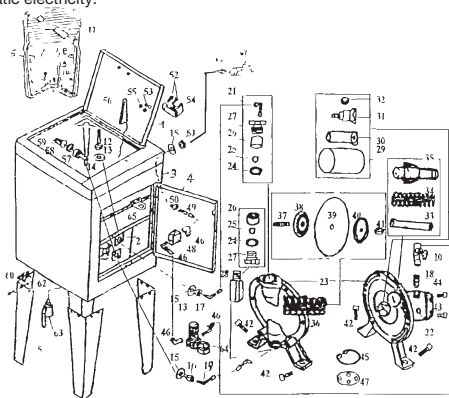

3. Assembly

Note: Item numbers in brackets are those in the attached Parts Diagram instructions should be read in conjunction with this diagram.

Attach legs to cabinet with screws (60), washers (61) and nuts (62) provided and fit drain valve (63) to base of tank (2).

To prevent possible static build up, run an earth wire from the frame to earth. Before operating the machine, user has to check the earth wire.

4. Air supply

Ensure that the air valve (64) is closed before connecting the air supply.

An air pressure of 2.8-4.2 kg/cm², and an available air volume of 0.06-0.11 m³/ min will be required to operate the unit.

WARNING! *Ensure air supply is clean and does not exceed 4.2 kg/cm². Too high an air pressure and/or unclean air will shorten the product life due to excessive wear and may be dangerous, causing possible damage and personal injury. Air supply must be equipped with regulator, filter/separator and oiler.*

Line pressure should be increased to compensate for unusually long air hoses (over 8 meters). The minimum hose internal diameter should be 10mm and fittings must have the same internal dimension.

Keep hose away from heat, oil and sharp edges. Check hoses for wear and make certain that all connections are secure.

The air inlet connection is 1/4" NPT.

5. Operation instructions

WARNING! *Ensure you follow the safety instructions. Wear approved safety gloves, respirator, and suitable clothing.*

WARNING! *Before using the washer always touches a suitable earthing point to dissipate any electrostatic charge you may have.*

PREPARING TANK & ITEMS FOR CLEANING

- Before opening the lid of tank to insert the spray gun, earth the metal body of the spray gun to bear metal contact on the cleaning machine to discharge any static electricity.
- Ensure tank drain ball valve (63) is closed and then pour solvent into tank (2). To aid future sludge removal approximately 2 litres of water may be added, either before or after the solvent. Ensure final level is at least 25mm (1 inch) above pump suction strainer (59)
- Confirm air valve (20) is closed and air supply pressure is regulated to not more than 4.2 kg/cm². Turn on air supply.
- Partially open air valve (20) and allow pump to run slowly for approx. 2 minutes to purge fluid used for manufacturer's tests.
- Check the spray gun to be cleaned, empty and store any excess paint for future use. For best results clean immediately after use, having removed as much residual paint as possible.
- To clean spray guns to squeeze trigger and fit trigger lock (56) as shown in Fig 1.
- Two gun supports are provided, one short (see Fig.2 A) and another long (see Fig2 B)
- Use whichever support suits the configuration of the gun to be cleaned In general, guns which have top entry paint inlets (e.g. gravity feed) can be put on either support provided they do not foul on the underside of the lid. Guns which have bottom entry paint inlets (e.g. suction feed) will usually go onto the longer support. If required gun cleaning nozzle (8) may be fitted directly to manifold (6) without item (9) and (10) thus providing two short nozzles.
- For pressure fed guns up to 2 liters capacity place the siphon stem of the pot cover over the short support and position the gun and hoses on the screen platform. Over this capacity disconnect the gun from the lines and place on the long support.
- Place pots over nozzles 'C',

6. Cleaning

- Ensure washer lid is closed and then fully open pump air valve (20).
- The pump will now operate and expel an atomized spray through the nozzles in the cleaning tank.
- Cleaning will be complete after 60 seconds, at which time pump should be turned off by closing air valve (20).
- Open lid and remove cleaned equipment.

If, during cleaning, lid is opened, cleaning process will automatically stop. Close lid to continue, DO NOT store guns in tank.

7. Solvent change & maintenance

WARNING! *It is operator's responsibility to ensure that there is no uncontrolled discharge of any fluids used with this unit and that appropriate arrangements have been made for correct disposal of waste in accordance with government/local authority regulations.*

WARNING! *Disconnect the air supply from the unit before changing accessories, servicing or performing any maintenance.*

WARNING! *Wear approved safety gloves, goggles, respirator and suitable clothing.*

- The number of guns the solvent can clean will depend upon the amount of residual paint, which is left in spray equipment. We recommend however that the solvent, is changed on a regular basis to provide optimum cleaning performance that pain sludge is removed weekly, as detailed below.

Sludge removal

- **No water added**— Drain 2 liters of solvent/sludge from drain valve (63). Close valve

(63). Close valve and add clean solvent to tank to bring level up to at least 25mm above strainer,

- **Water added** —Drain water until it becomes discolored, close drain valve. Change to 'dirty solvent' receptacle, re-open drain valve and drain 2 litres of solvent/sludge. Close valve, replace water in tank and then add clean solvent to bring level up to at least 25mm above strainer.
- Solvent change Completely drain dirty solvent as in 6-1-1. Clean inside of tank (2) and strainer (59) before refilling with clean solvent wipe up any spillage immediately.

8. Maintenance

- Regularly check that opening the washer lid automatically stops the spray.
- Regularly check and add air tool oil to air cock (67) on monthly basis.
- Keep the outside of the unit clean.
- Inject lubricant into air inlet every 3 month, see appendix I Fig. 11, or see 6-2-5.
- Use a hexagonal screwdriver in tool bag to open the circular cap of the pump and inject lubricant into it, see the picture below!

Warning! Clean water base paint gun and solvent base paint gun separately, do not clean both at the same time. Clean water base paint guns with 'Soap Water'.

Warning! Operation Instruction for Timer. Suggest turning the switch at 4 that allows the machine operates for about 3 minutes, a proper time to clean the gun. Do not turn the switch past 6, or damage would occur to the timer.

EC DECLARATION OF CONFORMITY



Name and address: PHU Thoma Tomasz Konopa
PL66-300 Międzyrzecz,
Winnica 36

herewith declares that:

Name / Model / Type **Spray Gun Washer**

Country of Origin: Taiwan
Year built: 2013

Air consumption: 150 l/min
Power: compressed air

are manufactured and tested according to the following standards:
EN ISO 12100-1:2003 | EN ISO 12100-2:2003 | EN ISO 14121-1:2007
ISO 13850:2006 | EN 60204-1:2006 | EN 983:2006

and are in conformity with the provisions of the Machinery Directive

2006/42/WE

94/9/WE

and with national implementing legislation.



08.09.2013, Międzyrzecz, Poland

Date and location

Tomasz Konopa, Chairman

Signature/ Full name in typing & position



Thoma

Tel./Fax: +48 95 741 11 62
info@t4w.eu • www.t4w.eu